

Letter to Byron Local Traffic Committee

Subject: Consideration of Byron Bay Lighthouse Run

22 October 2017 (BLR17)

Dear members,

We pleased to make application to the Local Traffic Committee for approval to conduct the 11th annual fundraising [Byron Bay Lighthouse Run](#) on Sunday 22nd October 2017.

The Byron Bay Lighthouse Run is a fun run and walk raising money for charity. In 2017 the event is supporting Crackin Cancer and Mai Wuru Foundation.

Consultation with the community and local businesses is essential in the planning of the Lighthouse Run; together with our proposed partners including Fusion, Byron Bay Brewery, Beach Café, Reindeer Riot, NXsports, Byron Hire, and Byron Shire Council, we will work to deliver a valuable economic and socially responsible project with perennial returns for stakeholders and our charitable partners.

The Lighthouse Run will attract about 900 participants, plus an estimated 1000 supporters. Based on our past experience, we anticipate that most competitors will be coming from Byron Shire, Ballina Shire, the Tweed, Southeast Queensland and regional areas.

We look forward to continuing the journey with the Byron community.

Please see attached helicopter view links for course map: <https://ridewithgps.com/routes/23984873>

Thank you.

Yours sincerely,



Mike Crawley

NXsports Community Foundation Limited

EVENT
MANAGERS

Race Director – Mike Crawley 0402 226 333

Event Manager – Lisa Parkes 0429 878 902

Event

22nd October 2017

Permits	Permits and approvals required from:- <ul style="list-style-type: none"> • NSW Police • Byron Shire Council • Local Traffic Committee • NSW National Parks • Cape Byron Trust 															
Stakeholders	The stakeholders identified and consulted with for the event are: <ul style="list-style-type: none"> • Byron Bay Surf Life Saving Club • Destination Byron • North Coast Holiday Parkes – Clarkes Beach • Shops/ businesses • Accommodation houses on Lighthouse Road • Accommodation houses on Palm Valley Drive, Marine Parade, Brownell Drive 															
Event Program	Sunday 22 October <ul style="list-style-type: none"> - 5.00am Registration Opens - 5.05am Coffee is Served - 6.45am Runners on course - 9.00am Presentations - 10.00am Complete site pack down. 															
Road Closure Detail	<table border="1" data-bbox="336 1108 1476 1317"> <thead> <tr> <th>Road</th> <th>Specification</th> <th>Time of Closure</th> </tr> </thead> <tbody> <tr> <td>Lawson Street</td> <td>From Massinger Street to Lighthouse Road</td> <td>6.30am to 10.00am</td> </tr> <tr> <td>Tallow Beach Road</td> <td>From Lighthouse Road to Tallow Beach Car Park</td> <td>6.30am to 10.00am</td> </tr> <tr> <td>Lighthouse Road</td> <td>From Lawson Street to Lighthouse</td> <td>6.30am to 10.00am</td> </tr> <tr> <td>Brooke Drive</td> <td>From Lighthouse Road to the Pass</td> <td>6.30am to 10.00am</td> </tr> </tbody> </table>	Road	Specification	Time of Closure	Lawson Street	From Massinger Street to Lighthouse Road	6.30am to 10.00am	Tallow Beach Road	From Lighthouse Road to Tallow Beach Car Park	6.30am to 10.00am	Lighthouse Road	From Lawson Street to Lighthouse	6.30am to 10.00am	Brooke Drive	From Lighthouse Road to the Pass	6.30am to 10.00am
Road	Specification	Time of Closure														
Lawson Street	From Massinger Street to Lighthouse Road	6.30am to 10.00am														
Tallow Beach Road	From Lighthouse Road to Tallow Beach Car Park	6.30am to 10.00am														
Lighthouse Road	From Lawson Street to Lighthouse	6.30am to 10.00am														
Brooke Drive	From Lighthouse Road to the Pass	6.30am to 10.00am														
Roads Impacted by Closure	<ul style="list-style-type: none"> • Patterson Street • Massinger Street • Mildenhall Road • Palm Valley Drive • Marine Parade • Brownell Drive • Julian Place • Pandanus Lane 															
Traffic Diversions During Closure	Traffic diversions are as per the traffic control plans. <table border="1" data-bbox="328 1854 1484 1973"> <thead> <tr> <th>Location</th> <th>Approaching</th> <th>Diversion</th> </tr> </thead> <tbody> <tr> <td>Massinger Street Northbound</td> <td>Lighthouse Road</td> <td>Left onto Lawson Street via traffic control</td> </tr> <tr> <td>Lawson Street Eastbound</td> <td>Lighthouse Road</td> <td>Right onto Massinger Street via traffic control</td> </tr> </tbody> </table>	Location	Approaching	Diversion	Massinger Street Northbound	Lighthouse Road	Left onto Lawson Street via traffic control	Lawson Street Eastbound	Lighthouse Road	Right onto Massinger Street via traffic control						
Location	Approaching	Diversion														
Massinger Street Northbound	Lighthouse Road	Left onto Lawson Street via traffic control														
Lawson Street Eastbound	Lighthouse Road	Right onto Massinger Street via traffic control														

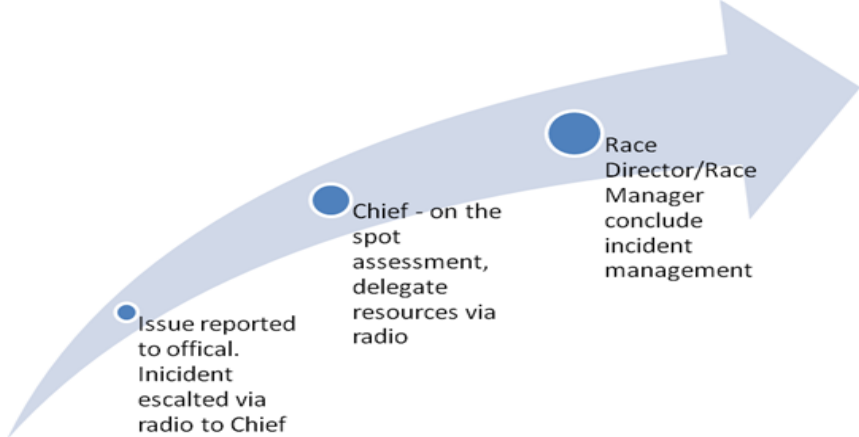

	<p>Outgoing traffic from the closed Lighthouse precinct will be guided by escort to the Lawson Street and Massinger Street intersection. Escorts will be available throughout the closure; the mobile number to arrange escort in advance is disseminated in all community consultation collateral.</p>
Special Event Signage	<p>Special Event signage will be installed in affected suburbs two weeks in advance of event.</p> <p>VMS electronic boards will be deployed 3 days in advance</p> <p>Signage on streets closed for the race installed 7 days prior.</p>
Residents Notification	<p>The Lighthouse Run to provide:</p> <ul style="list-style-type: none"> • Regular news releases to local papers starting 3 months out • Special Event Notices go into the Byron Echo 2 weeks out from the event • Promotional letterbox drops to all local residents and businesses affected in order to engage the community and gain their support. • Letterbox drop to residents and businesses affected two weeks prior to event • Residents will have access to the motorbike escort service for urgent entry/exit on routes. <p>All resident notification includes event contact mobile number.</p>
Business Consultation	<ul style="list-style-type: none"> • Consultation will be made with shop owners and accommodation houses in the precinct. • A door to door approach will be made to businesses on the Lighthouse peninsula northeast of the Lawson/Massinger roundabout.
Road Signage	<ul style="list-style-type: none"> • Road detour signage and appropriate traffic signage will be used in advance of key changed road conditions & activity areas as per Traffic Control Plan. • A major effort will be undertaken to promote special event and detour signage for persons on route to the Lighthouse during road closures. • An extensive campaign to participants will be undertaken to communicate detours, access roads before the weekend to minimise confusion. • Special Event Signage will be placed on all connected roads into the event.
Car Parking	<ul style="list-style-type: none"> • Most participants are anticipated to be local residents • Public carparking on Massinger Street and Lawson Street
Traffic Controllers	<ul style="list-style-type: none"> • Located as per the Traffic Control Plan
Road Marshals	<ul style="list-style-type: none"> • Located as per the Marshall Map
Escort	<ul style="list-style-type: none"> • Outgoing traffic via scooter escort. • Contact details to arrange escort in advance as per resident notification and business consultation collateral

<p>Risk Escalation</p>	<p>During racing, all matters of safety, risk management are controlled by the Race Director, who with the Event Manager will take appropriate action.</p> <ul style="list-style-type: none"> • Marshalls & Traffic Controllers – report injuries; resident issues; behavior incidents to race radio • Race Director/Race Manager assess risks, coordinate response with emergency services, first aiders. Council and Erection Crews 
<p>Major Incident</p>	<p>In the case of a major community incident, the event will be put on hold until the Race Director and Police determine when the event is safe to proceed.</p> <p>Race Director ensures that emergency services maintain right of way access to all closed roads.</p>
<p>First Aid</p>	<p>First aid is on site based from the Clarkes Beach Car Park and will be mobile on course as required.</p>
<p>Venues</p>	<ul style="list-style-type: none"> • The Erections crew will install forty rubbish bins and undertake a full site clean at the end of the event in conjunction with Solo Waste and Byron Shire Council. • Additional toilets will be provided at the Clarkes Beach Car Park. • Parking zones will be marshalled and be away from the central business district in Byron.
<p>Police Permit</p>	<p>Applications have been submitted to NSW Police</p>

Traffic Control Plan

www.invarion.com

Legend

-  Cone
-  Runners
-  traffic controller

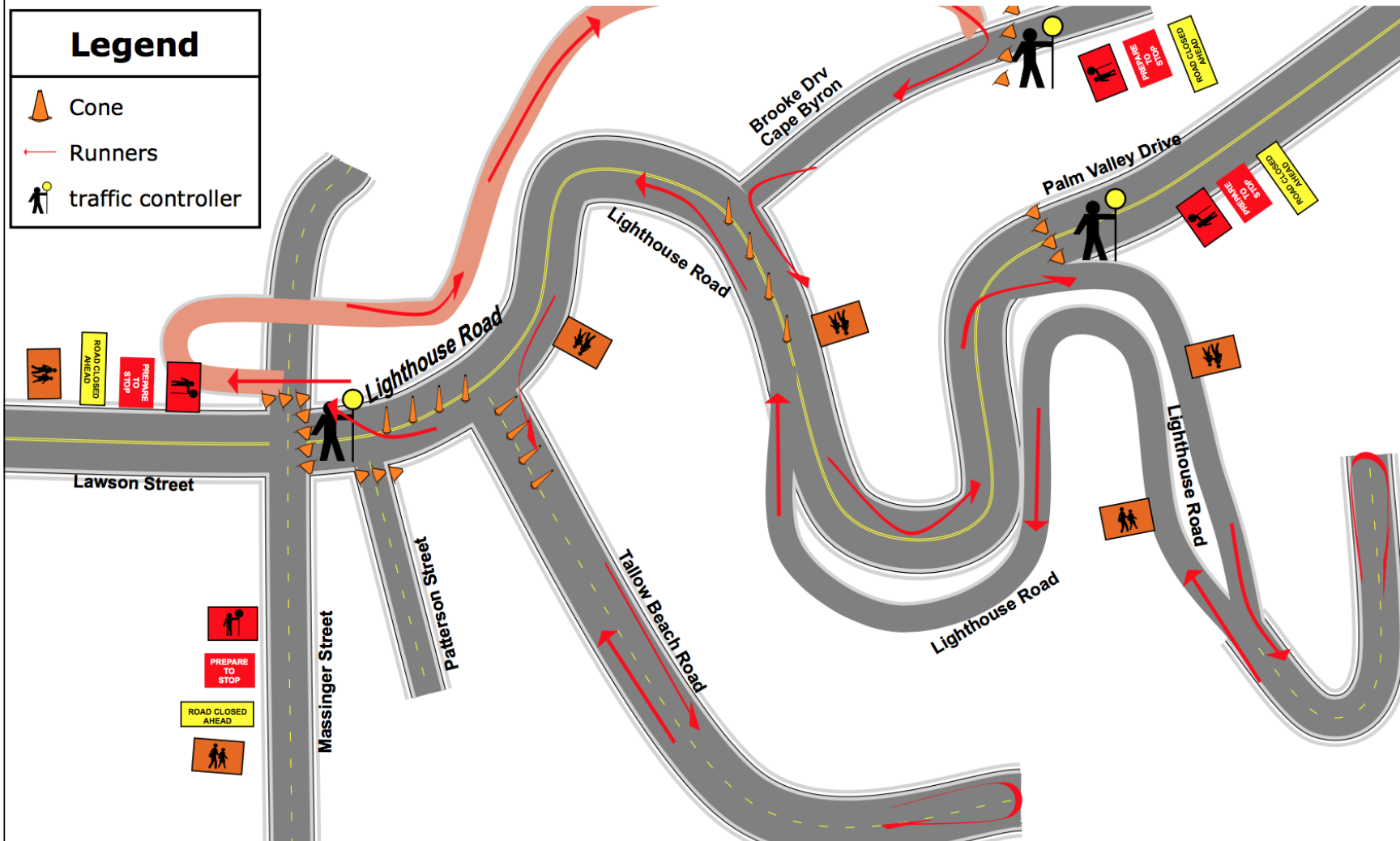

Street	Lawson-St- Lighthouse Rd	Start Date	15-10-2017	Notes - Plan Not To Scale. - This TCP Drawn in Accordance with AS1742.3 & RMS's TCAWS Manual. - This TCP to be used only by P.T.S. Traffic Representatives only who are RMS Accredited traffic controllers, and must carry their tickets at all times. - If this TCP is used in any OTHER way PTS Traffic will not be RESPONSIBLE. - Consider the use of a pilot vehicle or an extra T/C or marshal (to have Two way Radio) where SIGHT is limited. - Two-way Radios are a must for T/C on site at all times. - Signs to be DOUBLED when required Adjust signs spacing to address Corners, Curves, Crests, & cover all Conflicting Signage. - All PTS Traffic work vehicles are to be fitted with RMS approved Flashing Light at all times while on site.
Cross St	Massinger Street	Speed reduction	N/A	
Suburb	BYRON BAY	Operation	Byron Bay Fun run	
Client	NXSPORTS	TCP	Special Event Mod.	
Date Drawn	4-09-2017	Drawn By	Robert Carpenter	
Revised Date		RMS No	7283014508 Design & inspect	

Marshal Map

