

Banaglaow Rd - Pedestrian refuge and enhancement of existing pedestrian crossing at roundabout



Pedestrian refuge No 1

Best suitable location near RSL age care centre and bus stops. Further south or north pedestrian refuge will clash with auxiliary lanes and driveways

Pedestrian refuge to be as per AS1742.10 and RMS TDT 2011/01a

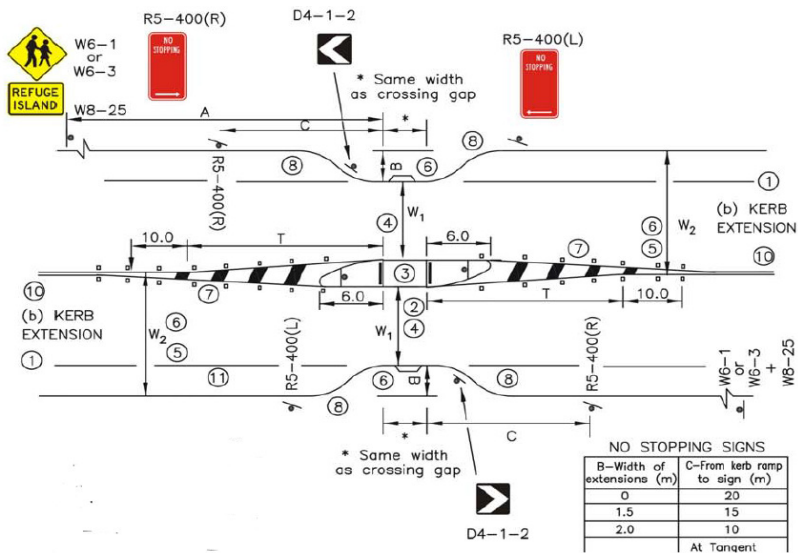

Pedestrian refuge No 2

Existing crossing is lacking hand rail, delineation, reflective markers, warning signage, line marking and raised reflective markers.

Install all of the above to enhance safety on existing crossing