

SDS Civil Enterprises

A.B.N. 56 656 467 255

461 Hinterland Way, Knockrow NSW

m 0438 725 414 e peterw@sdscivil.com.au

IMPORTANT NOTES

1. Verify and locate all dimensions and levels PRIOR to performing any works.
 2. Ensure DBYD enquiries are made to locate current service information.
 3. Pothole or service locator of any underground services before performing works.
 4. Drawing may not be modified or used by others without approval of SDS Civil Enterprises.
- © Copyright SDS Civil Enterprises

LEGEND

1080m ²	40mm AC 7mm Primer Seal 150mm DGB20 150mm DGS40 340mm Box Depth
81m ²	30mm AC Overlay/Corrector
339m ²	150mm Concrete 32Mpa SL82 Overlay 75mm DGB20 Prep Layer
435m ²	100mm Concrete Footpath 25Mpa SL62 (1.5m wide External) (1.2m wide Internal)
71m ²	150mm Concrete 32Mpa SL82 Driveway Crossing Overlay 75mm DGB20 Prep Layer
17m ²	Concrete Kerb Ramp
ER2	Edge Restraint Kerb Type as per NRLG Drg R-03
SM3	Semi-Mountable Kerb Type as per NRLG Drg R-03
Dish Gutter	600MM Invert Dish Gutter Type as per NRLG Drg R-03

(Note m² shown are Net Surface Areas Only)

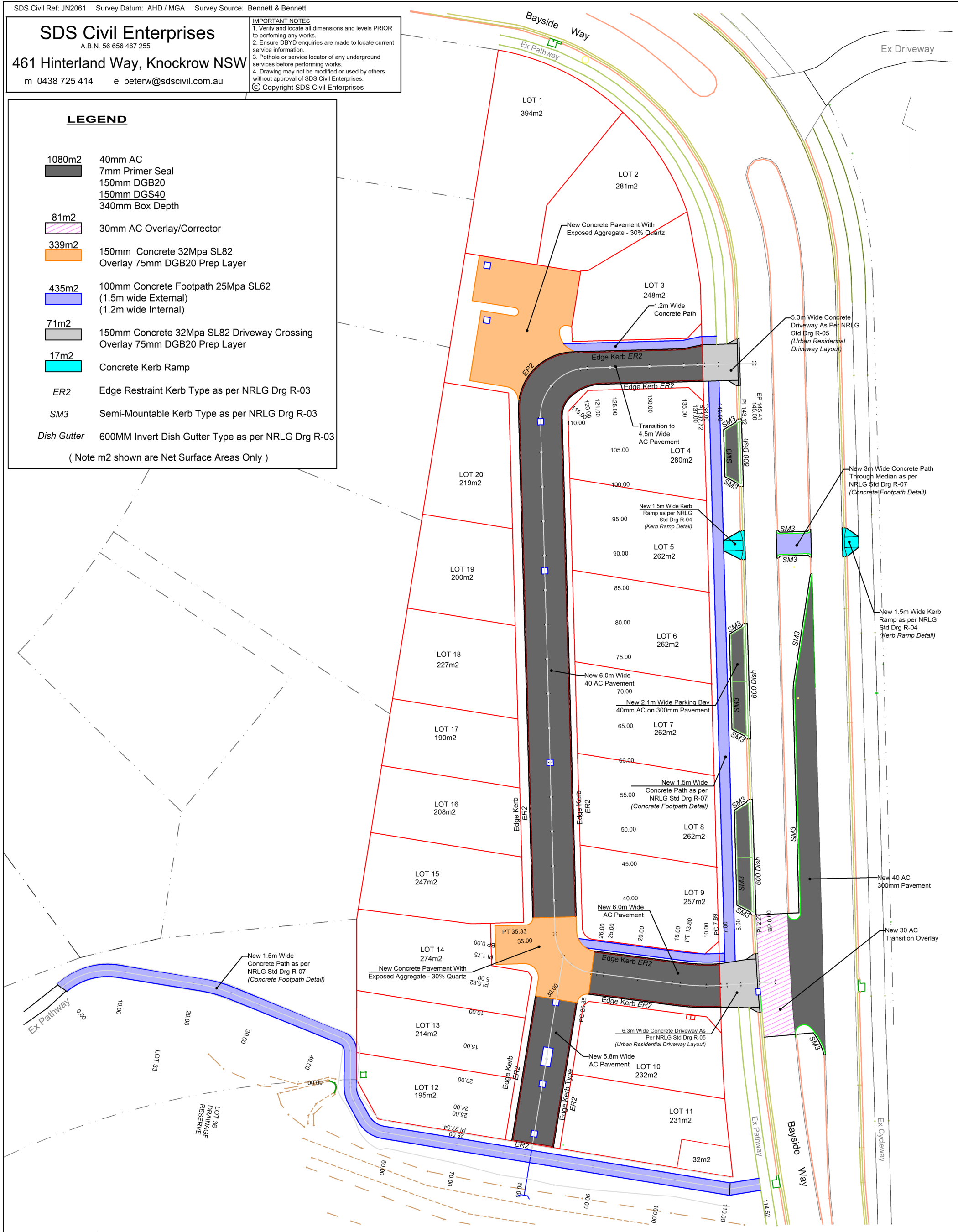

Rev	Date	Amendment	SCALE	PROJECT	Heathgrove	ADDRESS	35 Bayside Way Brunswick Heads	DATE	March 2022	REV
A			 1:500 at A3 UNO	CLIENT	J & G Mills	LAND	Lot 1 - 6 DP 1261870	DRAWING PURPOSE	Subdivision Works	
B				DRAWING DETAILS	New Pavement Plan and Kerb Type			DRAWING NUMBER	Civ - C1	
C			APPROVED							
D			Mr P Williams B.Eng (Civil)							

SDS Civil Enterprises

A.B.N. 56 656 467 255

461 Hinterland Way, Knockrow NSW

m 0438 725 414 e peterw@sdscivil.com.au

IMPORTANT NOTES

1. Verify and locate all dimensions and levels PRIOR to performing any works.
 2. Ensure DBYD enquiries are made to locate current service information.
 3. Pothole or service locator of any underground services before performing works.
 4. Drawing may not be modified or used by others without approval of SDS Civil Enterprises.
- © Copyright SDS Civil Enterprises

Refer to INSERT DETAIL

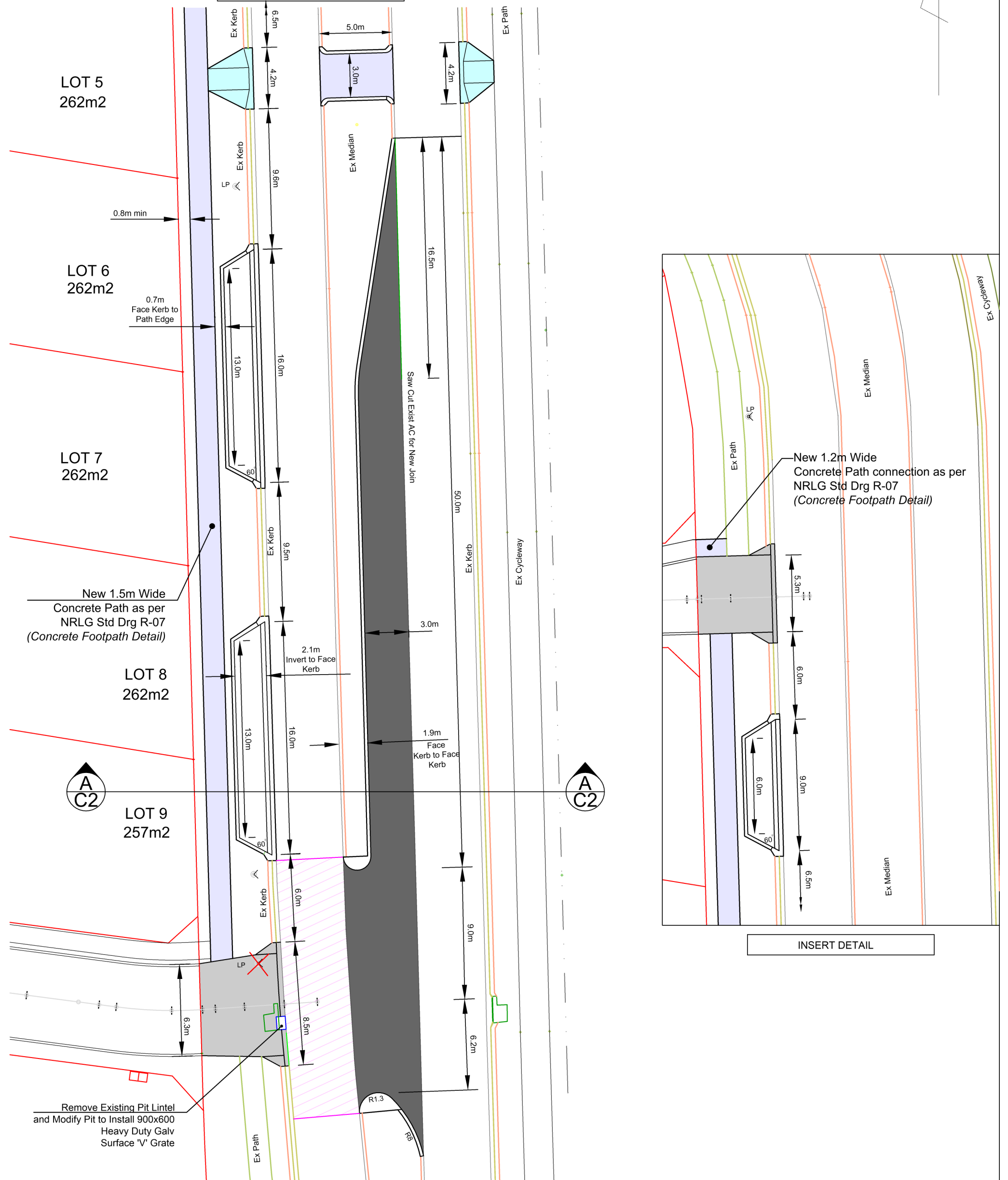

SDS Civil Ref: JN2061 Survey Datum: AHD / MGA Survey Source: Bennett & Bennett

Rev	Date	Amendment	SCALE	PROJECT	ADDRESS	DATE	REVISION
A			<p>SCALE</p> <p>1:250 at A3 UNO</p> <p>APPROVED</p> <p>Mr P Williams B.Eng (Civil)</p>	Heathgrove	35 Bayside Way Brunswick Heads	March 2022	
B				J & G Mills	Lot 1 - 6 DP 1261870	Subdivision Works	
C							
D							
				DRAWING PURPOSE	DRAWING NUMBER		
				Bayside Way Widening Works Dimensions		Civ - S138 - 1	