

# Waterlily Playscape - January 2020 Survey Results

## About you

What age group are you in ?

124 responses

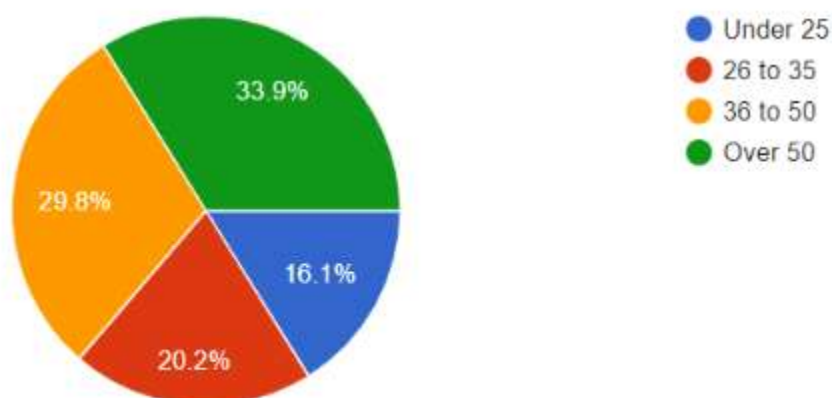

Nearly two thirds of survey respondents are over 36 years old.

How close to Waterlily Park, Ocean Shores do you live ?

124 responses

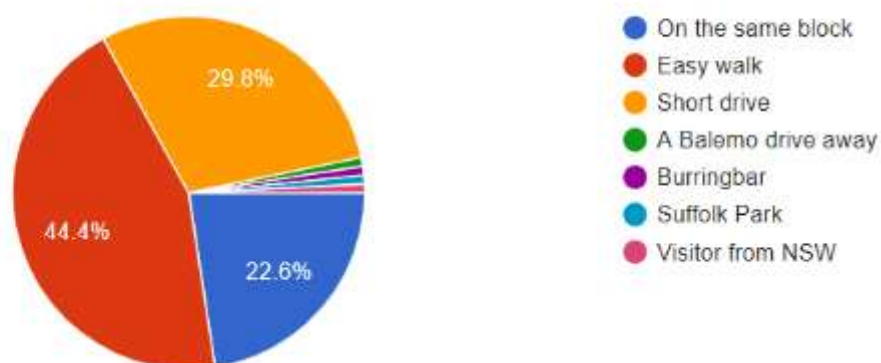

The park is mostly used by locals – 96.8% of survey respondents mentioned living near the park – on the same block, easy walk or a short drive

## How often do you use Waterlily Park?

124 responses

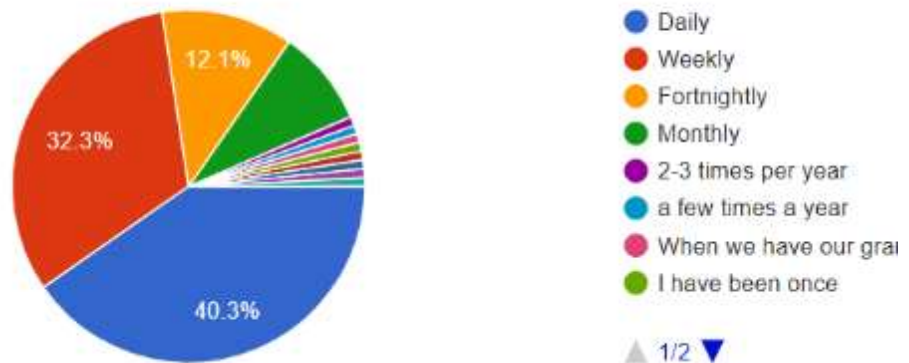

Which facilities would you like at the park? Please order your priorities from 1 – 7

**From left to right:** results presented from the most to the least preferred

**[Lowest score presents a higher priority]**

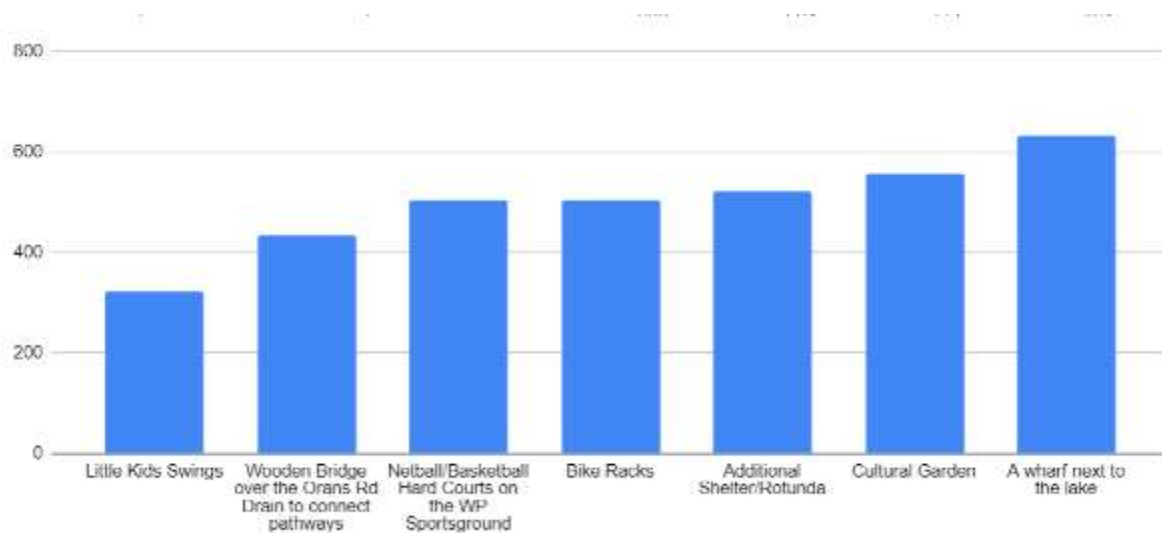

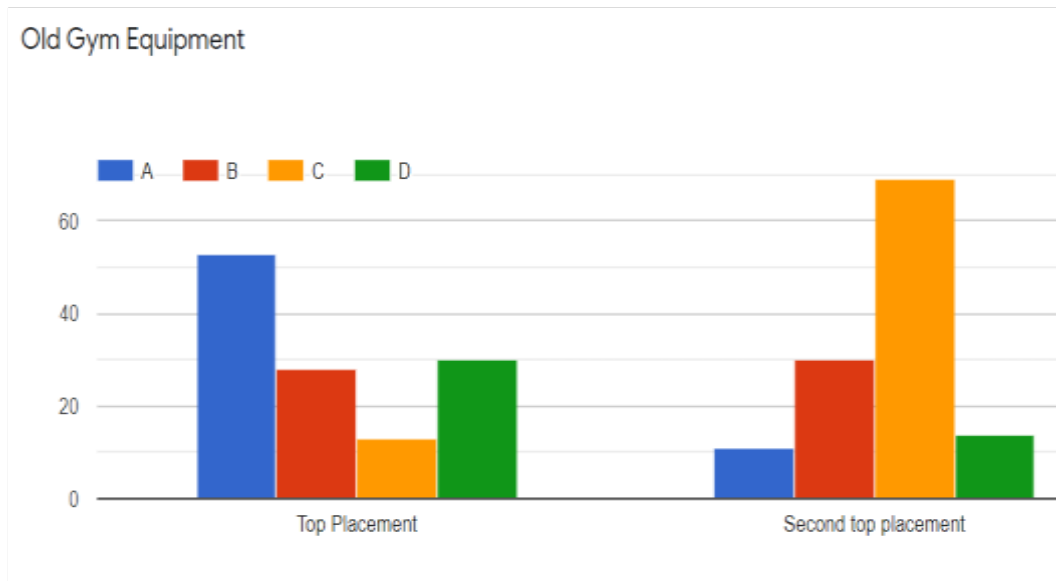

Top preferred location for the gym: A (53), followed by D (30), B (28), & C (13).

Second top placement: C (69), B (30), D (14) & A (11).

*Suggested old cardio gym equipment locations*





## Cultural Garden

124 responses



85.5% of respondents supported the original location suggested for the cultural garden (see map below)

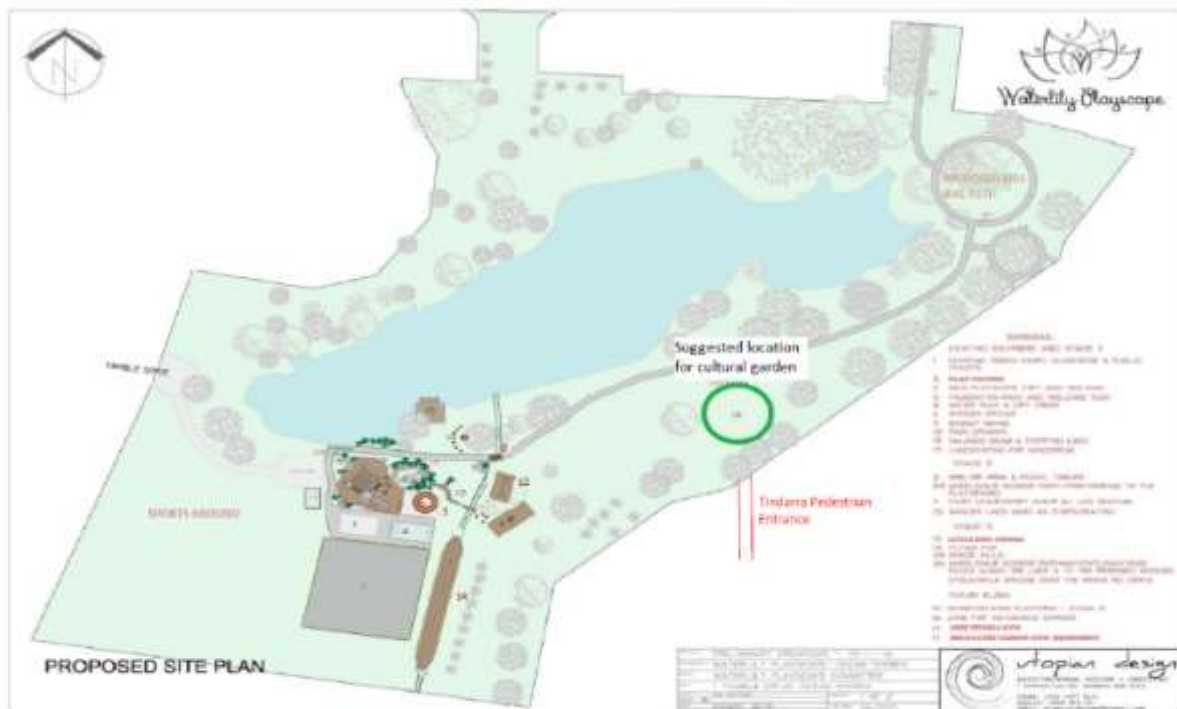

## Rotunda/Additional Shelter

124 responses

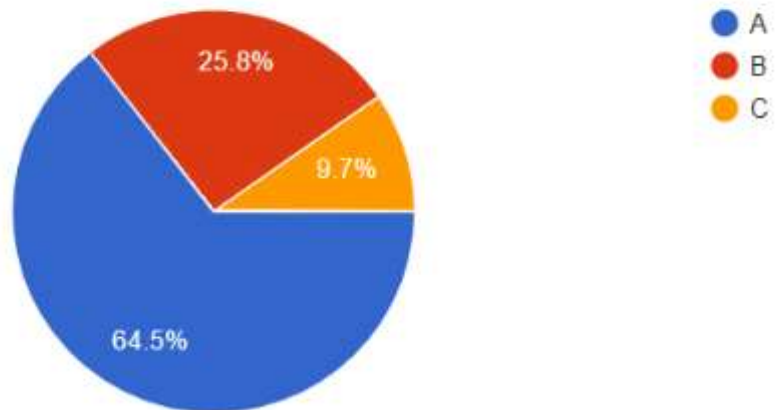

64.5% of participants preferred rotunda closer to the playground area





If you have any other thoughts on the park, please share them here...

67 comments were made. This is how they look in a word cloud:



Below are all comments:

1. A skate park would be great for older children
2. Basketball courts are for sure most important
3. Beautiful play area, but you need Council to keep off-lead dogs out of the play spaces as they pee on the poles. Very unhygienic, and poor handling by dog owners.
4. Bridge across orana drain and pathway on other side forming circuit around lake for cycling walking skating. Also off leash dog area Dandaloo way end of WL Park. :)
5. Bridge across orana drain and pathway on other side forming circuit around lake for cycling walking skating. Also off leash dog area Dandaloo way end of WL Park. :)
6. Can Council please finish the off-road cycleway in Balemo Drive and extend it around the corner in Orana Rd to connect to Waterlily Park and the Shopping Centre.
7. Can we have a footy field too
8. Can we have soccer nets too please
9. It would be great if we could have the same bike racks that Byron has in their parks please
10. Can we join the park pathway to an off road cycleway to the shops
11. Climbing equipment and swings for little kids. I have 2 grandchildren one aged 15 months and a 2 year old and it's quite difficult as a very tiny child, and also for the parent/grandparent with them in helping them with the quite high and difficult playground.. Once they are older and taller it will be wonderful but at the moment I feel accessibility for tiny kids is not great.
12. Connect footpaths from Balemo Dr to Waterlily Park please
13. Cool playground !
14. Definitely need more little kids and big kids (ie teen) activities.
15. Dog fenced area on the area adjacent to play ground. Stop the poo.

16. Council Rangers need to patrol the play ground area to stop uncaring owners letting their dogs poo there.
17. Dog off leash area on the area next to tennis with a seat. Also a couple of soccer posts for kids on the oval
18. Excellent playground, but we need more play spaces for little kids.
19. Fantastic Park
20. Give due consideration to issues affecting residents of properties adjoining the park, eg, privacy, lighting, noise, views, dust. Prevent people driving golf buggies and motorcycles through the park - drink-drivers and speeding vehicles currently present a very dangerous situation.
21. good survey
22. Great job so far ! We really do need the swings for the little kids back in the park now please.
23. Great park and loads of fun !
24. Having the bridge would mean not going to Brunswick for my walk to get the amount of walking needed.....I could do as many circuits as required. Waterlily Park is local & very pretty and I could just walk from my house.
25. "I am very appreciative of all the work done,"
26. Thank you for a beautiful park for all abilities.
27. My main interest would be a bridge linking the park around the lake. 🌳🌿🌸"
28. I loved the park
29. I think that all facilities should be grouped together, near the existing facilities and the carpark. i think the Orana Road end of the park should be left in its natural state - there is no parking at that end and its a good space for the many dog walkers.
30. I would like the gym equipment back a.s.a.p as told back in April,2019.
31. I would like a bridge to connect to a board walk to go completely around the park for walking, biking and for those in wheelchairs.
32. I'd love a dog off leash section
33. I'm in my 70s, and I walk through this park everyday for my exercise and to photograph the bird life. The new gym is very flimsy and useless for seniors. I'm glad you are bringing back the old gym along the pathway because it is much stronger than the new one, and better for seniors for muscle strengthening and cardio exercises. Thankyou, Potter
34. I've been using the park for my fitness classes and the addition of another shelter would be so amazing 😊
35. It looks beautiful, but babies and little kids need swings and play things too
36. It would be good if council regularly cleaned up fallen timber, some of which is termite infested (especially if contractors felled the timber and just left it where it fell).
37. "It would be great for the kids to have safe/off road cycling from the Nth Ocean Shores Sportsfield, along Balemo Dr to connect to Waterlily Park on Orana Rd.
38. Thanks for all your hard work Waterlily Playscape crew. So awesome ! "
39. It would be great to have events here for youth as there is very little this end of the shire for them to do.
40. It would be nice to leave the undeveloped part of the park just as is to enjoy the unspoilt nature.
41. Lock the flying fox at night as there is too much youth running around & vandalism going on
42. Love the flying fox and the whole park.
43. Love, love, love this park !
44. More shade would be good...



45. Please consider the locals who live on the park, they have to put up with the increased noise & vandalism at all hours of the day & night. They are the most important people to consult.
46. Please keep all the children's activities up near the carpark. Many older people use the park too, so please keep the Orana Road end untouched, for passive activities such as Tai Chi, dog walking, and just sitting enjoying the quiet of nature.. Please more swings for our little ones.
47. Slide for younger children
48. The Council Rangers need to stop dog owners walking their dogs off lead early in the morning and letting their dogs pee under the playground equipment
49. The drainage around the park and lake/ bridge needs serious attention. The flow inlets into the lake are completely insufficient. Unless this is addressed when the rains come the area in between the swing and the playground will be a swamp and unless the bridge drains and flows into the bridge and past the bridge (golf course side) are well maintained there is a danger the whole playground will get flooded as in a couple of years back.
50. The facilities are well used, but definitely require more tables and chairs, with shade cover
51. The flying fox is a winner with everyone, need to build another one even better
52. The little kids swings were removed 3 years ago, and they should be replaced asap
53. The little kids swings were taken out years ago. Why didnt Byron Council replace them sooner for the little kids ?
54. The park looks fantastic, can we have hard court netball this time.
55. The return of old gym equipment was promised on 23/4/19.
56. There seems to be a late night noise issues happening especially over the weekend . This is disturbing adjoining homes that may need to be addressed if not already . May need CCTV monitoring .
57. Theres a group of youths who come into the park and throw their weight around. We need infra-red CCTV to put a stop to their bad behaviour and smashing bottles please.
58. Think about teenagers: maybe box track, skate bowl
59. "This is a magnificent natural space for all ages and abilities, and a credit to the hard working Committee."
60. The wide cycleway in the Park now is fantastic too, and hopefully our Council will connect the Sportsfield to Waterlily Park through Balemo Drive, Orana Rd, and then connect to our Shopping Centre via Warrambool Dr to the current pathway on Rajah Rd. "
61. This Park needs CCTV to stop vandalism from a small group of youth who are also terrorising the other kids
62. toilets need to be kept cleaned and locked at night, I've never seen a scene more revolting last I was there
63. Upgrade of the toilet block would be a massive improvement
64. We love the flying fox, and the basketball/netball courts would be great for the younger generation.
65. We love the park! Thanks for all your good work.
66. When and if you get the bridge, I would like to see a boardwalk around the lake on the other side from all the facilities.
67. You need to connect the Nth OS sportsfield with an off road cycleway to Waterlily Park please.