

**In accordance with 'Bush Fire Assessment Report**  
(CNR-7391) 10.2020.2015.1

**General Conditions:**

1. The development proposal is to comply with the drawing titled 'Site Plan - Overall' submitted as Appendix A of the 'Bush Fire Assessment Report' prepared by Bushfire Certifiers dated 3rd April, 2020.
2. At the commencement of building works or issue of a subdivision certificate (whichever comes first), and in perpetuity to ensure ongoing protection from the impact of bush fires, the entire site must be managed as an inner protection area (IPA) in accordance with the requirements of Appendix 4 of Planning for Bush Fire Protection 2019. When establishing and maintaining an IPA the following requirements apply:

- tree canopy cover should be less than 15% at maturity;
- trees at maturity should not touch or overhang the building;
- lower limbs should be removed up to a height of 2 m above the ground;
- tree canopies should be separated by 2 to 5 m;
- preference should be given to smooth barked and evergreen trees;
- large discontinuities or gaps in vegetation should be provided to slow down or break the progress of fire towards buildings;
- shrubs should not be located under trees;
- shrubs should not form more than 10% ground cover;
- clumps of shrubs should be separated from exposed windows and doors by a distance of at least twice the height of the vegetation;
- grass should be kept mown (as a guide grass should be kept to no more than 100 mm in height); and - leaves and vegetation debris should be removed.

All construction to comply with the NCC. Check and verify all dimensions and levels on site prior to commencement of construction.  
Do not scale, use written dimensions only.  
Site levels are shown as a guide only. Survey levels to be prepared by a registered surveyor.

© Copyright 2020 - Kris McFadden Design.  
All rights reserved



**Kris McFadden Design**  
ph. 0400 891 266  
[www.kmddesign.com.au](http://www.kmddesign.com.au)



Drawing  
Title  
Client  
Address

**OVERVIEW**  
**MR Z KENNEDY**  
**KEATS ST BYRON BAY N.S.W. 2481**  
**AUSTRALIA**

Project ID KEATS SUB DIVISION  
Sheet 2 of 22  
Rev 003  
Drawn By Kris McFadden  
Checked   
Date 21/12/20  
Scale 1:500

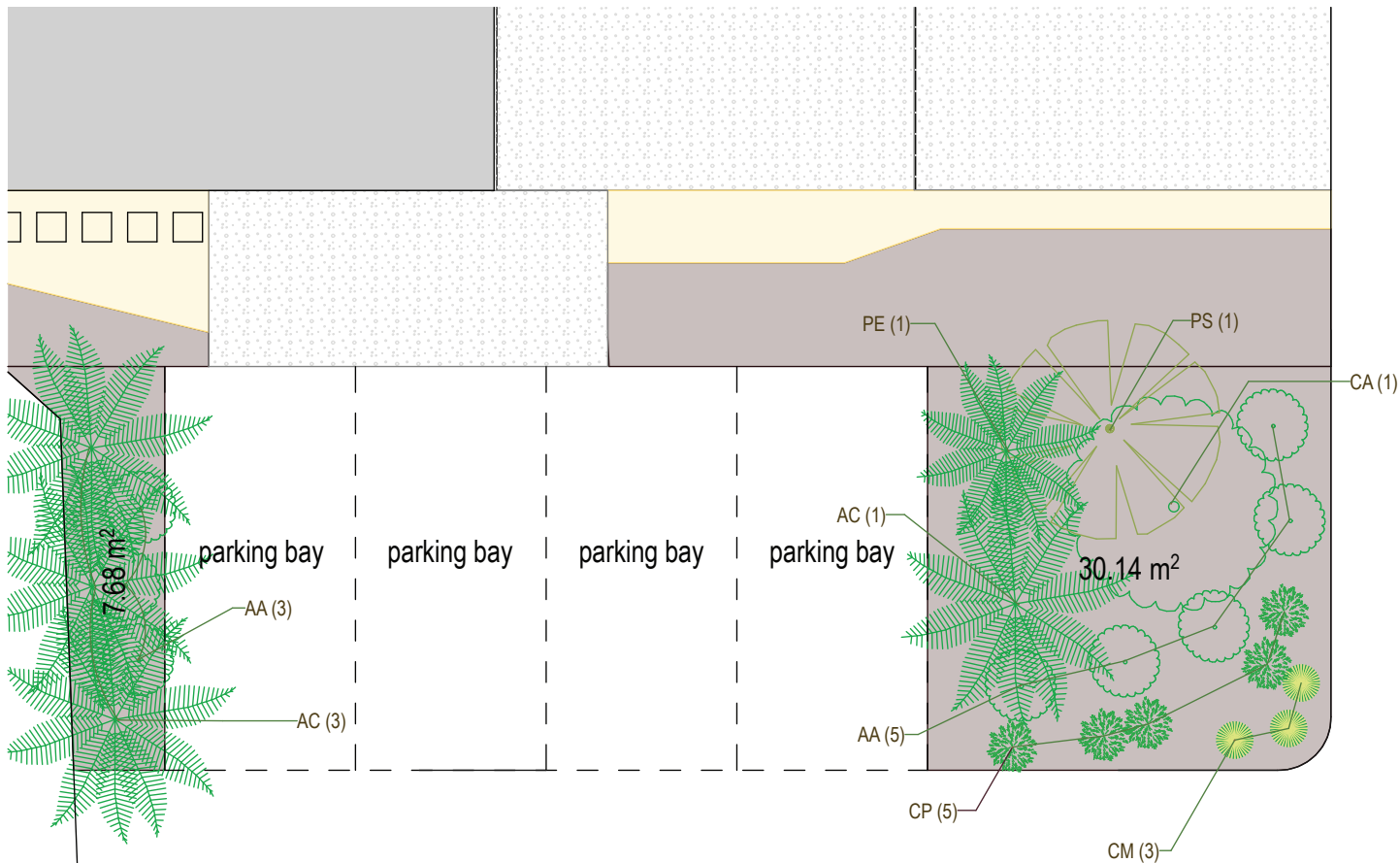

DRIVEWAY

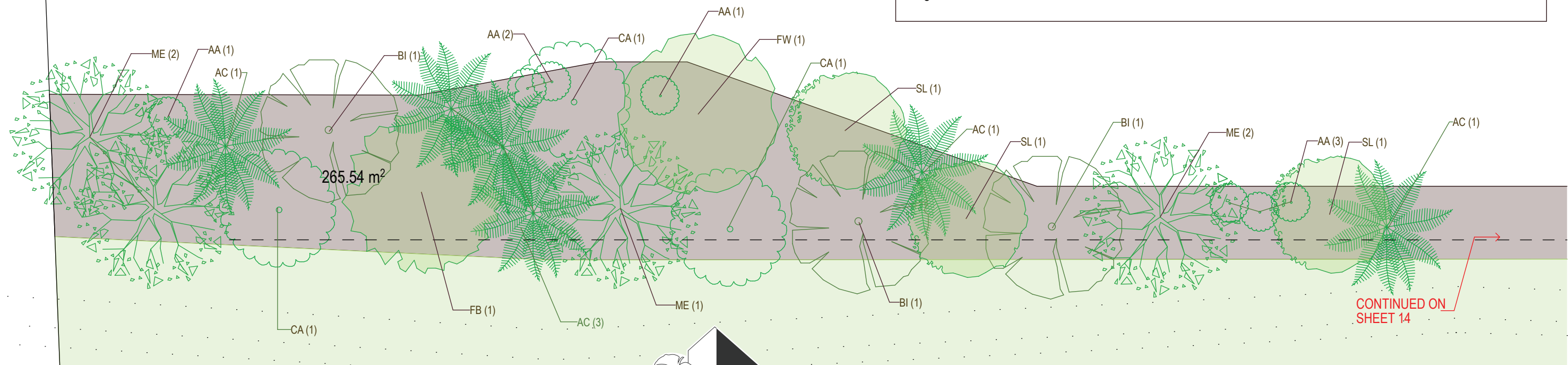

In accordance with 'Bush Fire Assessment Report  
(CNR-7391) 10.2020.2015.1

General Conditions:

1. The development proposal is to comply with the drawing titled 'Site Plan - Overall' submitted as Appendix A of the 'Bush Fire Assessment Report' prepared by Bushfire Certifiers dated 3rd April, 2020.
2. At the commencement of building works or issue of a subdivision certificate (whichever comes first), and in perpetuity to ensure ongoing protection from the impact of bush fires, the entire site must be managed as an inner protection area (IPA) in accordance with the requirements of Appendix 4 of Planning for Bush Fire Protection 2019. When establishing and maintaining an IPA the following requirements apply:
  - tree canopy cover should be less than 15% at maturity;
  - trees at maturity should not touch or overhang the building;
  - lower limbs should be removed up to a height of 2 m above the ground;
  - tree canopies should be separated by 2 to 5 m;
  - preference should be given to smooth barked and evergreen trees;
  - large discontinuities or gaps in vegetation should be provided to slow down or break the progress of fire towards buildings;
  - shrubs should not be located under trees;
  - shrubs should not form more than 10% ground cover;
  - clumps of shrubs should be separated from exposed windows and doors by a distance of at least twice the height of the vegetation;
  - grass should be kept mown (as a guide grass should be kept to no more than 100 mm in height); and - leaves and vegetation debris should be removed.

All construction to comply with the NCC. Check and verify all dimensions and levels on site prior to commencement of construction.  
Do not scale, use written dimensions only.  
Site levels are shown as a guide only. Survey levels to be prepared by a registered surveyor.

© Copyright 2020 - Kris McFadden Design.  
All rights reserved



**Kris McFadden Design**  
ph. 0400 891 266  
[www.kmdesign.com.au](http://www.kmdesign.com.au)



Drawing  
Title  
Client  
Address

**DRIVEWAY detail 01**  
**MR Z KENNEDY**  
**KEATS ST BYRON BAY N.S.W. 2481**  
**AUSTRALIA**

Project ID KEATS SUB DIVISION  
Sheet 13 of 22  
Rev 003  
Drawn By Kris McFadden  
Checked   
Date 21/12/20  
Scale 1:100



6

7

**In accordance with 'Bush Fire Assessment Report**  
(CNR-7391) 10.2020.2015.1

**General Conditions:**

1. The development proposal is to comply with the drawing titled 'Site Plan - Overall' submitted as Appendix A of the 'Bush Fire Assessment Report' prepared by Bushfire Certifiers dated 3rd April, 2020.
2. At the commencement of building works or issue of a subdivision certificate (whichever comes first), and in perpetuity to ensure ongoing protection from the impact of bush fires, the entire site must be managed as an inner protection area (IPA) in accordance with the requirements of Appendix 4 of Planning for Bush Fire Protection 2019. When establishing and maintaining an IPA the following requirements apply:

- tree canopy cover should be less than 15% at maturity;
- trees at maturity should not touch or overhang the building;
- lower limbs should be removed up to a height of 2 m above the ground;
- tree canopies should be separated by 2 to 5 m;
- preference should be given to smooth barked and evergreen trees;
- large discontinuities or gaps in vegetation should be provided to slow down or break the progress of fire towards buildings;
- shrubs should not be located under trees;
- shrubs should not form more than 10% ground cover;
- clumps of shrubs should be separated from exposed windows and doors by a distance of at least twice the height of the vegetation;
- grass should be kept mown (as a guide grass should be kept to no more than 100 mm in height); and - leaves and vegetation debris should be removed.

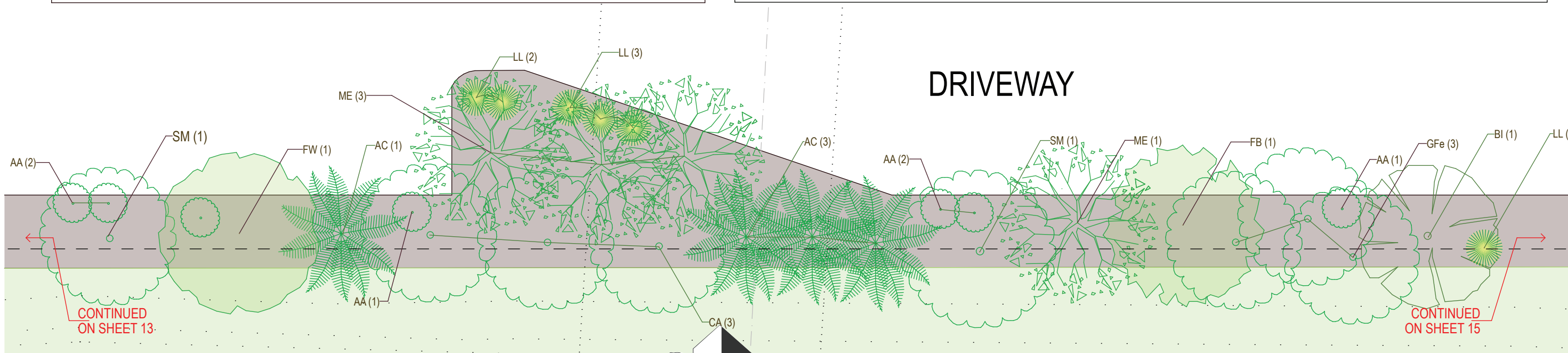
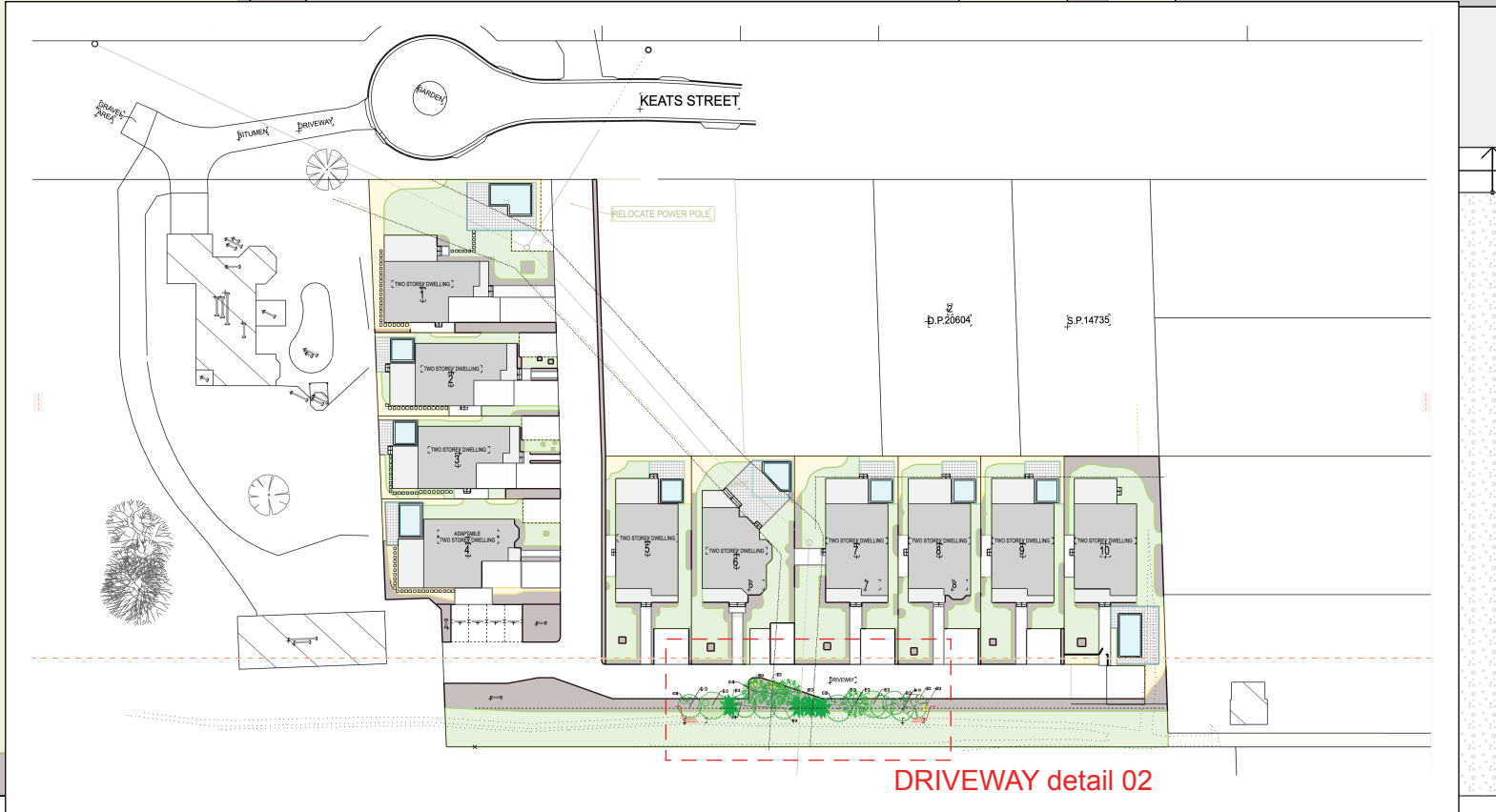

All construction to comply with the NCC. Check and verify all dimensions and levels on site prior to commencement of construction.  
Do not scale, use written dimensions only.  
Site levels are shown as a guide only. Survey levels to be prepared by a registered surveyor.

© Copyright 2020 - Kris McFadden Design.  
All rights reserved



**Kris McFadden Design**  
ph. 0400 891 266  
[www.kmddesign.com.au](http://www.kmddesign.com.au)



Drawing Title  
Client  
Address

**DRIVEWAY detail 02**  
**MR Z KENNEDY**  
**KEATS ST BYRON BAY N.S.W. 2481**  
**AUSTRALIA**

Project ID KEATS SUB DIVISION  
Sheet 14 of 22  
Rev 003  
Drawn By Kris McFadden  
Checked   
Date 21/12/20  
Scale 1:100

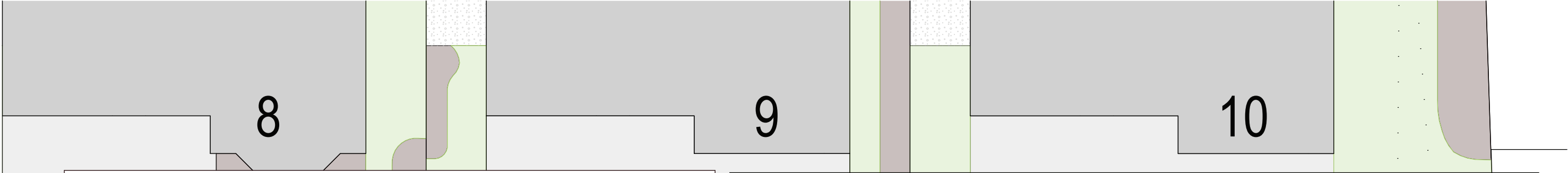

**In accordance with 'Bush Fire Assessment Report (CNR-7391) 10.2020.2015.1**

**General Conditions:**

1. The development proposal is to comply with the drawing titled 'Site Plan - Overall' submitted as Appendix A of the 'Bush Fire Assessment Report' prepared by Bushfire Certifiers dated 3rd April, 2020.

2. At the commencement of building works or issue of a subdivision certificate (whichever comes first), and in perpetuity to ensure ongoing protection from the impact of bush fires, the entire site must be managed as an inner protection area (IPA) in accordance with the requirements of Appendix 4 of Planning for Bush Fire Protection 2019. When establishing and maintaining an IPA the following requirements apply:

- tree canopy cover should be less than 15% at maturity;
- trees at maturity should not touch or overhang the building;
- lower limbs should be removed up to a height of 2 m above the ground;
- tree canopies should be separated by 2 to 5 m;
- preference should be given to smooth barked and evergreen trees;
- large discontinuities or gaps in vegetation should be provided to slow down or break the progress of fire towards buildings;
- shrubs should not be located under trees;
- shrubs should not form more than 10% ground cover;
- clumps of shrubs should be separated from exposed windows and doors by a distance of at least twice the height of the vegetation;
- grass should be kept mown (as a guide grass should be kept to no more than 100 mm in height); and - leaves and vegetation debris should be removed.

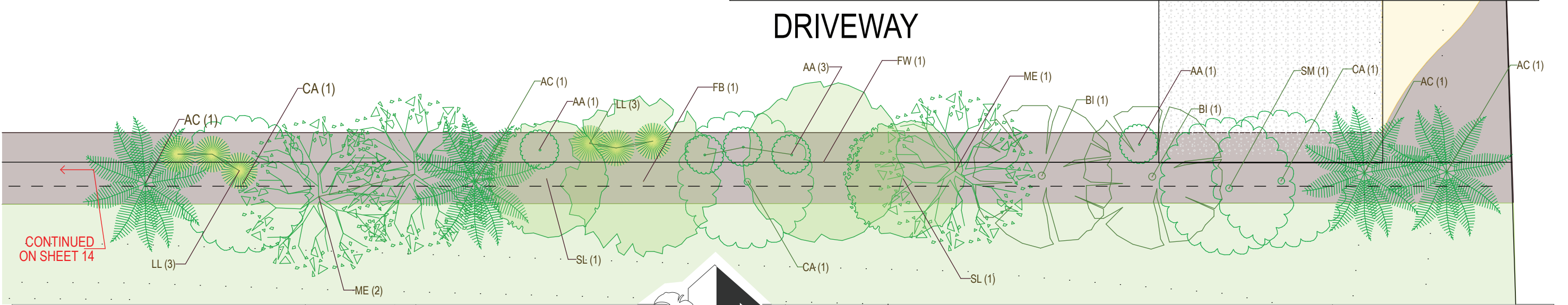

All construction to comply with the NCC. Check and verify all dimensions and levels on site prior to commencement of construction. Do not scale, use written dimensions only. Site levels are shown as a guide only. Survey levels to be prepared by a registered surveyor.

© Copyright 2020 - Kris McFadden Design. All rights reserved

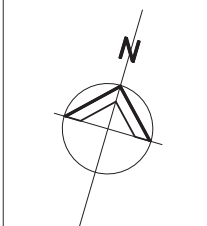

**Kris McFadden Design**  
ph. 0400 891 266  
www.kmdesign.com.au

Drawing Title  
Client  
Address

**DRIVEWAY detail 03**  
**MR Z KENNEDY**  
**KEATS ST BYRON BAY N.S.W. 2481**  
**AUSTRALIA**

Project ID	KEATS SUB DIVISION
Sheet	15 of 22
Rev	003
Drawn By	Kris McFadden
Checked	
Date	21/12/20
Scale	1:100



PLANTING DETAIL

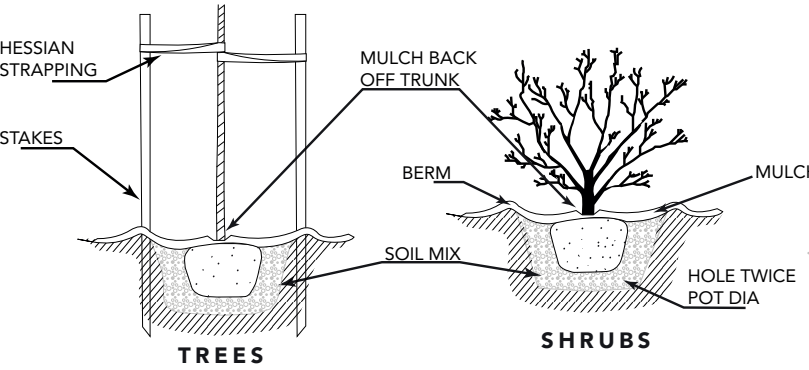

TYPICAL GARDEN BED PREPARATION

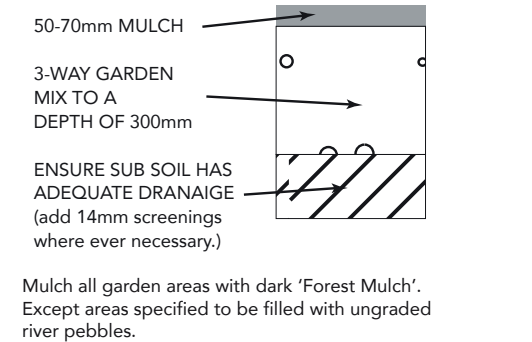

SOIL PREPARATION TURF AREAS

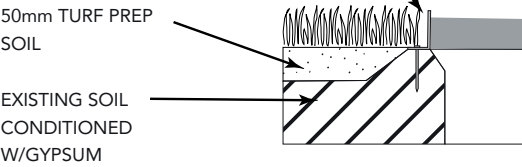

PAVING SPECIFICATIONS

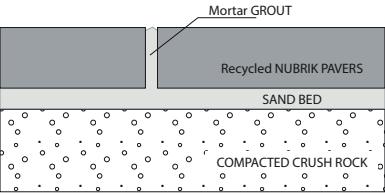

PAVING INSTALLED ON A SCREEDED SAND BED ON TOP OF A 80mm COMPACTED CRUSH ROCK BASE - MORTAR GROUT. ALL PAVING TO DRAIN TO GARDEN AREAS WHERE POSSIBLE.

PLANTING SCHEDULE

							INDIVIDUAL DWELLING QTY'S												
Code	Botanical Name	Common Name	Habit	Height - Typical (m)	Pot Size	QTY	1	2	3	4	5	6	7	8	9	10	DWY		
AA	Alpinia arundelliana	Native Ginger	Sh	0.5-1	200	27											27		
AF	Atractocarpus Fitzalanii	Native Gardenia	ST	5-8	200	2					2								
AC	Archontophoenix cunninghamiana	Bangalow Palm	P	8-20	200	59	8	9	6	3	4	4	3	1	2	2	17		
BA	Banksia aemula	Wallum Banksia	ST	5-8	140	1										1			
BE	Banksia ericifolia subsp. macrantha	Heath-leaved Banksia	Sh	2-5	140	2						1				1			
BI	Banksia integrifolia subsp. integrifolia	Coastal Banksia	T	5-8	200	8							1			2	5		
CA	Cupaniopsis anacardioides	Tuckeroo	T	8-20	300	22	1	2	3	3	1		1	1	1	1	8		
CC	Chamaedorea Cataractarum	Cascade Palm	P	1-2	140	54	5	2	1	7	3	2	10	6	6	12			
CM	Carex Maculata	A Sedge	G	0.5-1	140	3											3		
CR	Cordyline rubra	Palm-Lily	Sh	2-5	140	30	3	1	1	3	5	5	3	1	3	5			
DD	Dianella Variegated	Variegated Dianella	G	0.5	140	76	8	13	4	9		5	8	7	8	14			
DR	Dianella revoluta	Blueberry Lily	H	<0.5	140	31		9	14	8									
FB	Flindersia bennettiana	Bennett's Ash	T	20-50	50L	3											3		
FW	Ficus watkinsiana	Strangler Fig	T	30	50L	3											3		
GFe	Glochidion ferdinandi	Cheese Tree	T	20-50	50L	3											3		
GF	Gardenia Florida	Gardenia	Sh	1	140	40	12				8	6	4	5	5				
GM	Gardenia Magnifica	Gardenia	Sh	1.5-2	140	121	38	6	6	8	13	15	9	8	9	9			
HA	Heliconia Angusta	Heliconia	Z	0.7	140	54	2	4	5	4	7	7	4	10	9	2			
HB	Heliconia Bihai	Heliconia Lobster Claw	Z	1.5	140	34			3	3	2	3	6	9	5	3			
HE	Heliconia Episcopalis	Heliconia Spear	Z	2	200	18				1			2	13		2			
HL	Heliconia Lingulata	Heliconia Flat Fan	Z	2-3	200	3							3						
HLo	Heliconia Latspatha 'Orange Gyro'	Orange Gyro	Z	1.8-2.5	200	24	6		2	1		1			9	5			
HP	Heliconia Psittacorum	Parrot Heliconia	Z	0.9-1.8	140	27	1	3		1	6	3	5	3	5				
HR	Heliconia Rostrata 'Nana'	Parrots Beak	Z	2-2.5	200	12							12						
HS	Heliconia Stricta 'Bucky'	Heliconia Bucky	Z	1-1.5	140	69	5	6	9	9	10	14			4	12			
HY	Hymenocallis	Spider Lilly	G	0.5	140	226	38	3	3	7	40	38	29	30	30	8			
LH	Lomandra hystrix	A Mat-rush	G	G	140	5										5			
LI	Lagerstroemia Indica	Crepe Myrtle	T	5	300	6	1			2		1	1	1					
LL	Lomandra longifolia	Spirn-headed Mat-rush	G	G	140	22				2						8	12		
LS	Leptospermum Scoparium Nanum	Dwarf Red Teatree	Sh	1	140	6	6												
MA	Melaleuca Acacioides	Coastal Paper Bark	T	10	200	6						1	1	1	1	2			
MD	Monstera Deliciosa	Monstera	Sh	1-2	200	3										3			
ME	Melicope Elleryana	Pink Euodia	T	15-20	200	10											10		
MG	Magnolia Grandiflora Teddy Bear	Magnolia Teddy Bear	ST	3	200	28	6				2	2	4	7	5	2			
PC	Pheonix Canariensis	Canary Island Palm	P	10-20	50L	8	1			1	1	1	1	1	1	1			
PE	Ptychosperma Elegans	Solitare Palm	P	5-10	300	21	6	1	2	3	1		1	2	1	3	1		
PS	Pandanus Spiralis	Pandanus, Screw palm	P	5-10	300	11	2		2	1		1	1	1	1	2			
PX	Philodendron Xanadu	Xanadu	Sh	0.5-1	140	82		11	14	32	13	9	3						
RE	Rhapis Excelsa	Rhapis Palm	P	1-2	250	9	3				3		3						
SM	Syzygium luehmannii	Lilly Pilly	T	30	300												5		
SM	Syzygium moorei	Durobby	T	20-50	300	6			1			1				1	3		
SN	Strelitzia Nicolai	Giant Bird of Paradise	Z	3-6	250	88	9	2	6	11	9	10	5	11	11	14			
SR	Syzygium Australe Resilience	Lilly Pilly	T	4	300	177	24	21	8		37		3				84		
TL	Tristaniopsis Laurina	Water gum	T	5-15	40L	5			1	1		3							

All construction to comply with the NCC. Check and verify all dimensions and levels on site prior to commencement of construction. Do not scale, use written dimensions only. Site levels are shown as a guide only. Survey levels to be prepared by a registered surveyor.

© Copyright 2020 - Kris McFadden Design. All rights reserved

**Kris McFadden Design**  
ph. 0400 891 266  
www.kmdesign.com.au

Drawing Title  
Client  
Address

**PLANTING SCHEDULE**  
**MR Z KENNEDY**  
**KEATS ST BYRON BAY N.S.W. 2481**  
**AUSTRALIA**

Project ID  
Sheet  
Rev  
Drawn By  
Checked  
Date  
Scale

KEATS SUB DIVISION  
19 of 22  
003  
Kris McFadden  
  
21/12/20